

Roof turbine ventilator WD-A-TURBO



Description

WD-TURBO roof turbine ventilators cap the exhaust end of ventilation ductwork or a flue stack.

They spin by the force of wind. By this effect and the specially designed geometry of the turbine bell vanes, the ventilator sucks out the air (or flue gas, as the case may be) to the outside.

The roof turbine ventilators enhance the stack draught effect and provide protection against ingress of rain, snow and condensation.

Symbols:

Material:

- A - aluminium
- K - stainless steel

Connection type:

- K - round bell with baseplate
- KK - round bell with flange
- KNS - round bell with male connector
- P - flat with baseplate

Product code example

Product code: **WD - A - TURBO - K - aaa**

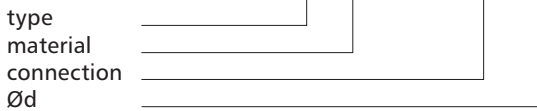

Dimensions

WD-A-TURBO-KNS

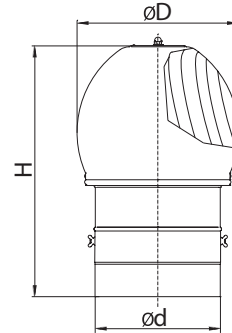

WD-A-TURBO-KK

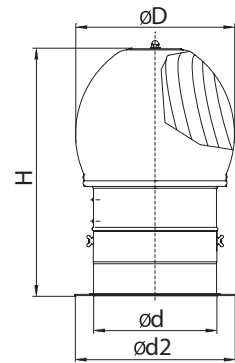

WD-A-TURBO-K

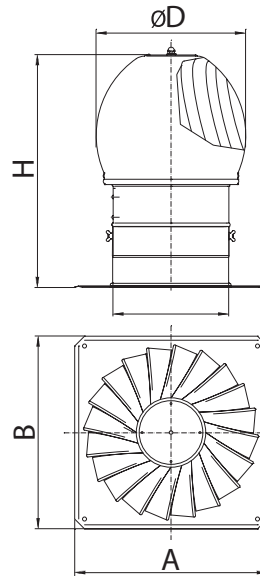

WD-A-TURBO-P

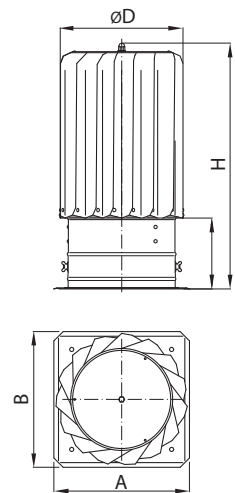

	$\varnothing d_{nom}$ [mm]	$\varnothing d_2$ [mm]	$\varnothing D_{nom}$ [mm]	H [mm]	A [mm]	B [mm]
male	150	-	225	337	-	-
	160	-	240	409	-	-
	200	-	300	409	-	-
	250	-	360	475	-	-
flanged	300	-	430	532	-	-
	150	210	225	217	-	-
	160	220	240	222	-	-
	200	260	300	283	-	-
w/base	250	310	360	365	-	-
	300	360	430	412	-	-
	150	-	225	217	333	333
	160	-	240	222	333	333
slim	200	-	300	283	333	333
	250	-	360	365	390	390
	300	-	430	412	440	440