

Fire damper with air valve

CFDM-V



Description

CFDM-V device combine features of dish air valve and shut-off fire valvr. It is an alternative for standard fire valvr. Main advantages of CFDM-V are high fire resistance classification, small dimensions and more versatile application.

Basic element of the device is fire damper CFDM. It is available in sizes Ø 100, 125, 160, 200 mm. Butterfly design of the damper ensures low pressure drop. As an option it can be equipped with one or two limit switches signalling position of the damper blades.

CFDM-V can be delivered with supply or extract dish valve.

CFDM-V device is designed to be mounted in the vertical or horizontal fire partitions. To mount the device, first make installation opening in the wall, install the device in proper place and then fill the gap with fire resistant sealant.

Available versions:

- 01 - thermal protective fuse
- 11 - thermal protective fuse + limit switch
- 15 - thermal protective fuse + 2 x limit switches
- KN - limit switches
- KW - extract dish valve

Product code example

Product code: **CFDM-V - 90 - 01 - KN - 100**

fire damper
fire resitnace EIS
options
valve type
Ø valve

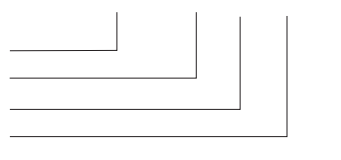

Dimensions

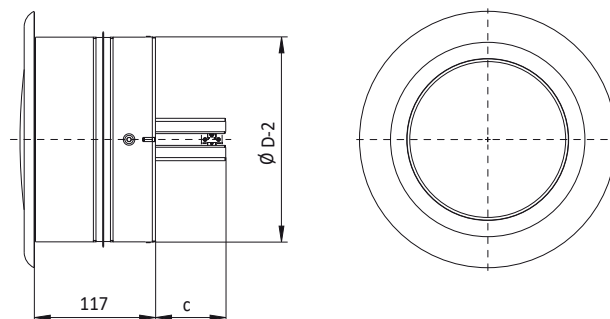

ØD [mm]	Length [mm]	Length C [mm]	Effective surface A_{ef} [m ²]
100	117	17.5	0.0030
125	117	30.2	0.0060
160	117	48	0.0119
200	117	68	0.0209

Design

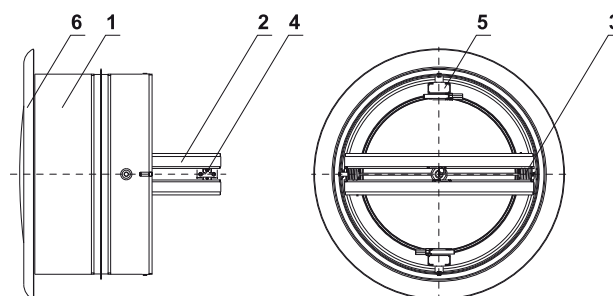

1. Damper casing.
2. Damper blade.
3. Shutting spring.
4. Thermal fuse.
5. Locking planchet.
6. Dish valve.

Fire damper with air valve

CFDM-V

Tests and certificates

- Fire resistance EIS 120, EIS 90, EIS 60 according to standard 13501-3+A1:2010
- CE certified according to standard EN 15650:2010

Selection charts

Air flow for fire damper with supply dish valve:

CFDM-V-KN-100

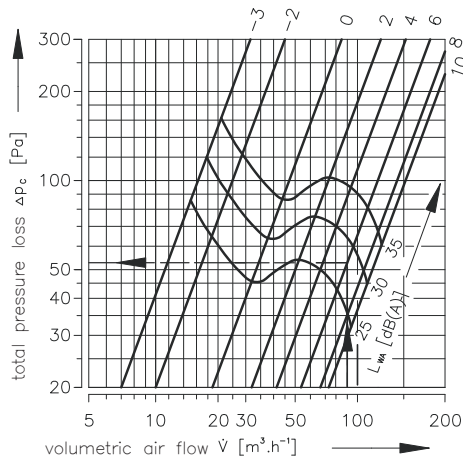

CFDM-V-KN-125

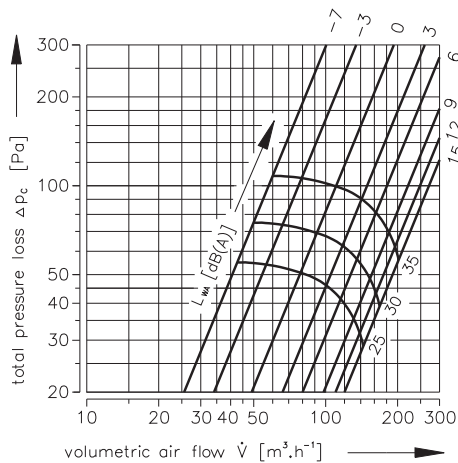

CFDM-V-KN-160

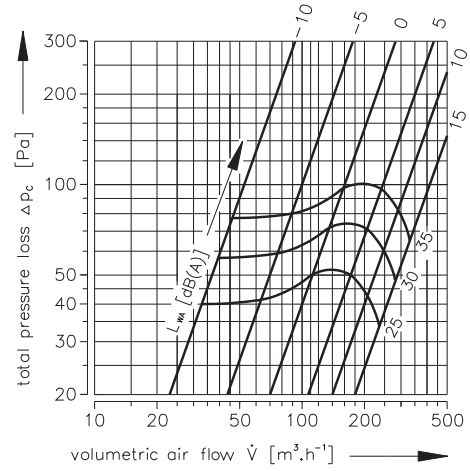

CFDM-V-KN-200

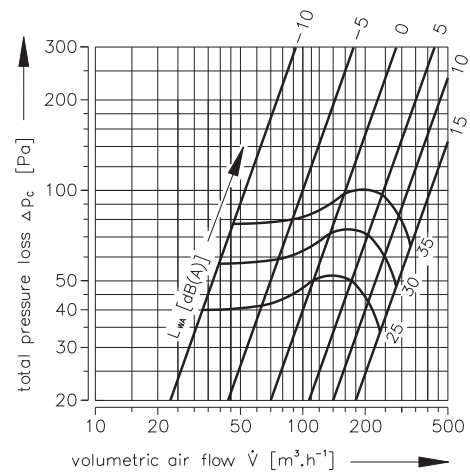

Air flow for fire damper with extract dish valve:

CFDM-V-KW-100

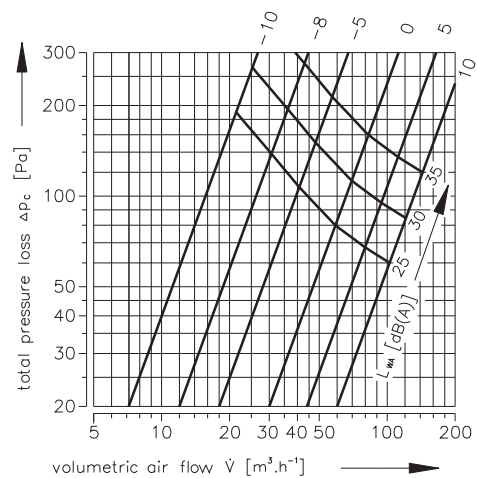

Fire damper with air valve

CFDM-V

CFDM-V-KW-125

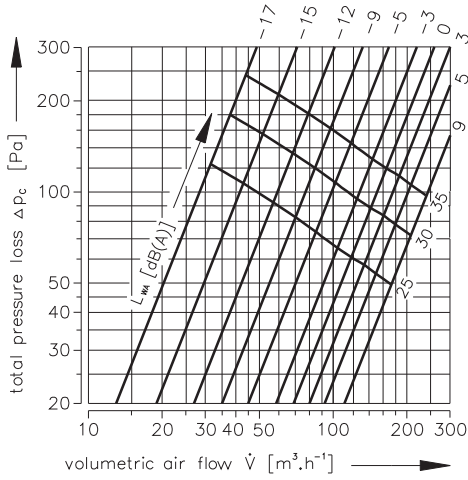

CFDM-V-KW-160

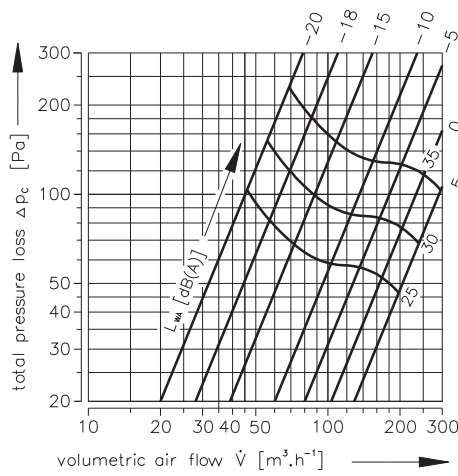

CFDM-V-KW-200

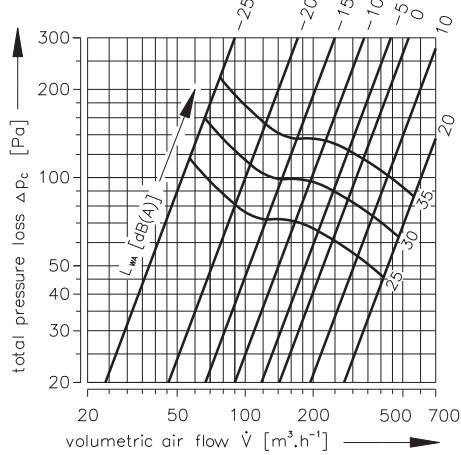

Installation

Installation of the CFDM-V fire damper with supply/ extract dish valve in gypsum wall construction.

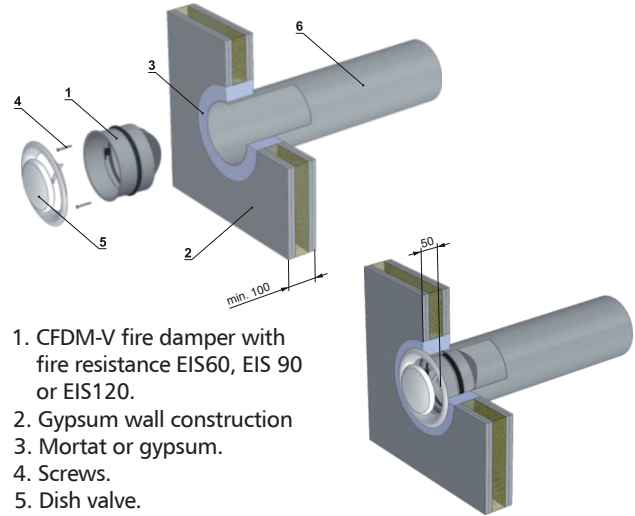

1. CFDM-V fire damper with fire resistance EIS60, EIS 90 or EIS120.
2. Gypsum wall construction
3. Mortar or gypsum.
4. Screws.
5. Dish valve.
6. Steel duct

Install duct together with construction edge. Install the fire damper in the duct so that the curved edge of the housing fits against the surface of the wall. Insert the fire damper housing in the duct and screw to the construction. Insert the valve into the housing.